

A

B

C

D

E

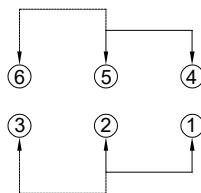
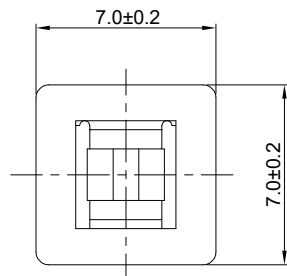

CIRCUIT DIAGRAM

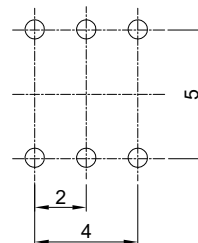
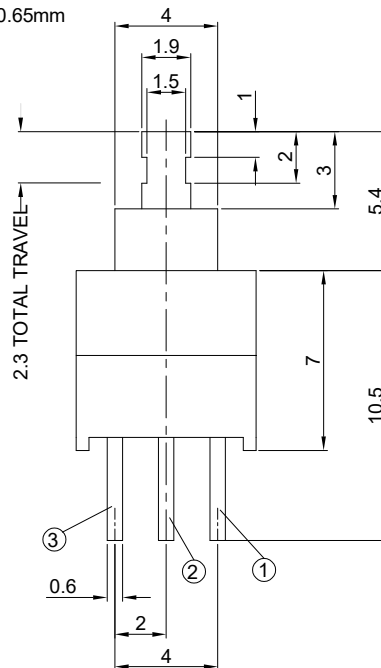
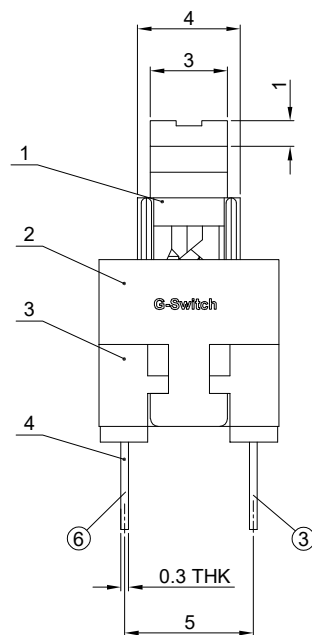
RECOMMENDED PCB LAYOUT
TOLERANCE:±0.05**PUSH-ON:**2-3,5-6 Conduction
Contact Travel: 1.0-1.15mm**PUSH-OFF**1-2,4-5 Conduction
Contact Travel: 0.5-0.65mm

2.3 TOTAL TRAVEL

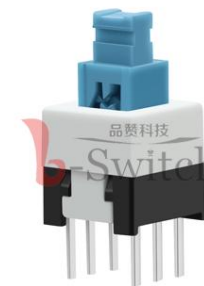
**PS-70 54 D V X- 6P N**

Push Switch

Switch Type
70=7.0×7.0mmSwitch Height
54=5.4mmFoot Type
D=DIPSwitch Function
N=No Lock
L=LockFoot Position
6P=6pinOperating Force
A=180gf
B=250gf
D=400gfType
V=Vertical**G-Switch Specification:**

1. Operating temperature range: -40°C ~ +85°C
2. Rating: 0.5A, 24V DC
3. Insulation resistance: 100MΩ min. 100V DC
4. Dielectric strength: 500V AC for 1 min
5. Contact resistance: 100mΩ max.
6. Poles-Throws: 2P2T
7. Switch lifetime: 10,000 Cycles

5	SPRING	SUS	NATURAL
4	TERMINAL	BRASS STRIP	Ag PIATED
3	CASE	NYLON PA66	BLACK
2	COVER	NYLON PA66	WHITE
1	KNOB	NYLON/PBS STRIP	BLUE/Ag CLAD
NO.	PART NAME	MATERIAL	REMARK

RoHS
Compliant
EU RoHS Standards

SCALE: 1:1

UNIT: mm

SIZE: A4

Title: Vertical Push Switch
DIP 7.0×7.0×12.4mmUnless otherwise
General Tolerance:≥10 ±0.30
1.5-10 ±0.20
≤1.5 ±0.10

Molde Code: PS-7054DVX-6PN

DRAWN	CHECKED	APPROVED	DATE
Xia	Chen	Chen	2023.02.01

品赞科技®
www.dg-switch.com

REV: A0

SHEET: 1/1