

GT-A1201 H M-1 XX X 01

G-Switch

Series No

Connector
H-Housing

M-Male

Housing Colour
B-Black

Pin Q' PY
02~10

Row NO
1-Single Row

G-Switch Specification:

1. Current rated: 1.5A AC/DC
2. Voltage rating: 50V AC/DC
3. Withstanding voltage: 500V AC
4. Contact resistance: 20mΩ max.
5. Insulation resistance: 100MΩ min
6. Durability cycle: 10Cycles
7. Removal force: 0.05kgf/Pin min
8. Operating temperature range: -25°C ~ +85°C

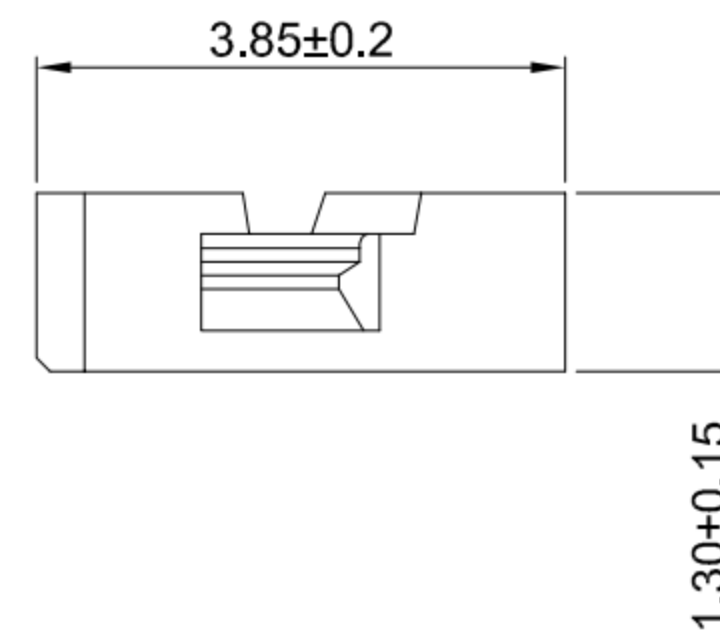
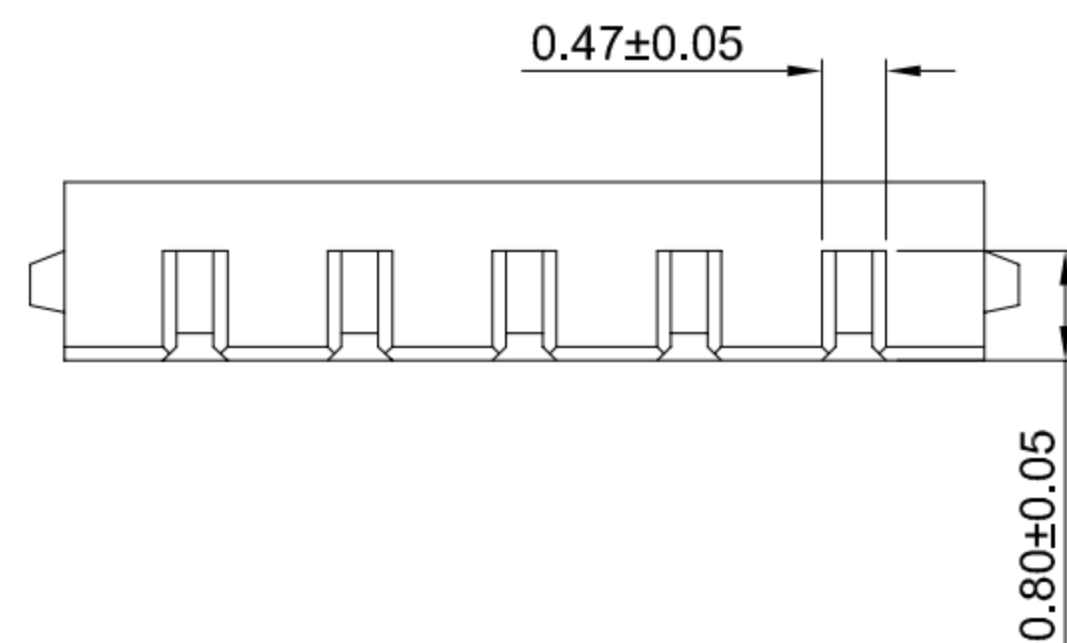

Ordering Information:

Circuit	Dimensions (mm)			Circuit	Dimensions (mm)		
	A	B	C		A	B	C
02	1.20	3.10	2.60	06	6.00	7.90	7.40
03	2.40	4.30	3.80	07	7.20	9.10	8.60
04	3.60	5.50	5.00	09	9.60	11.50	11.00
05	4.80	6.70	6.20	10	10.80	12.70	12.20

NO.	PART NAME	MATERIAL	REMARK
1	HOUSING	LCP,94V-0	BLACK



SCALE: 1:1 UNIT: mm
SIZE: A4

Unless otherwise
General Tolerance:
X ±0.40
X.x ±0.30
X.xx ±0.20
X* ±5°
X.x° ±3°

Title: Housing 1.20mm Pitch Single Row Male

Molde Code: GT-A1201HM-1XXX01

DRAWN	CHECKED	APPROVED	DATE
Hu	Chen	Chen	2022.12.28



REV: A0 SHEET: 1/1