

GT-B0405 M S V 12 -XX X XX 01

- G-Switch**
- Series No**
- M-Male**
- Termipoint**
S-SMT
- Angle**
V-180°
- Terminal Plating**
11-All Au G/F
- Housing Colour**
B-Black
- Pin Q' PY**
10~80
- Height**
12-1.25mm

- G-Switch Specification:**
- 1.Current rated: 0.3A AC/DC
 - 2.Voltage rating: 60V AC/DC
 - 3.Withstanding voltage: 150V AC
 - 4.Contact resistance: 70mΩ max.
 - 5.Insulation resistance: 1000MΩ min
 - 6.Durability cycle: 50 Cycles
 - 7.Removal force: 0.005kgf/Pin min
 - 8.Operating temperature range: -55°C ~ +85°C

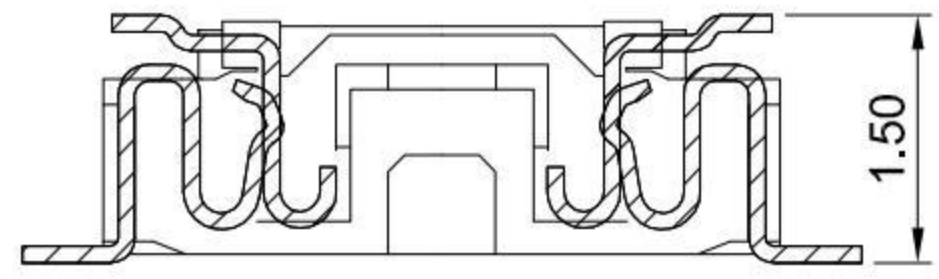
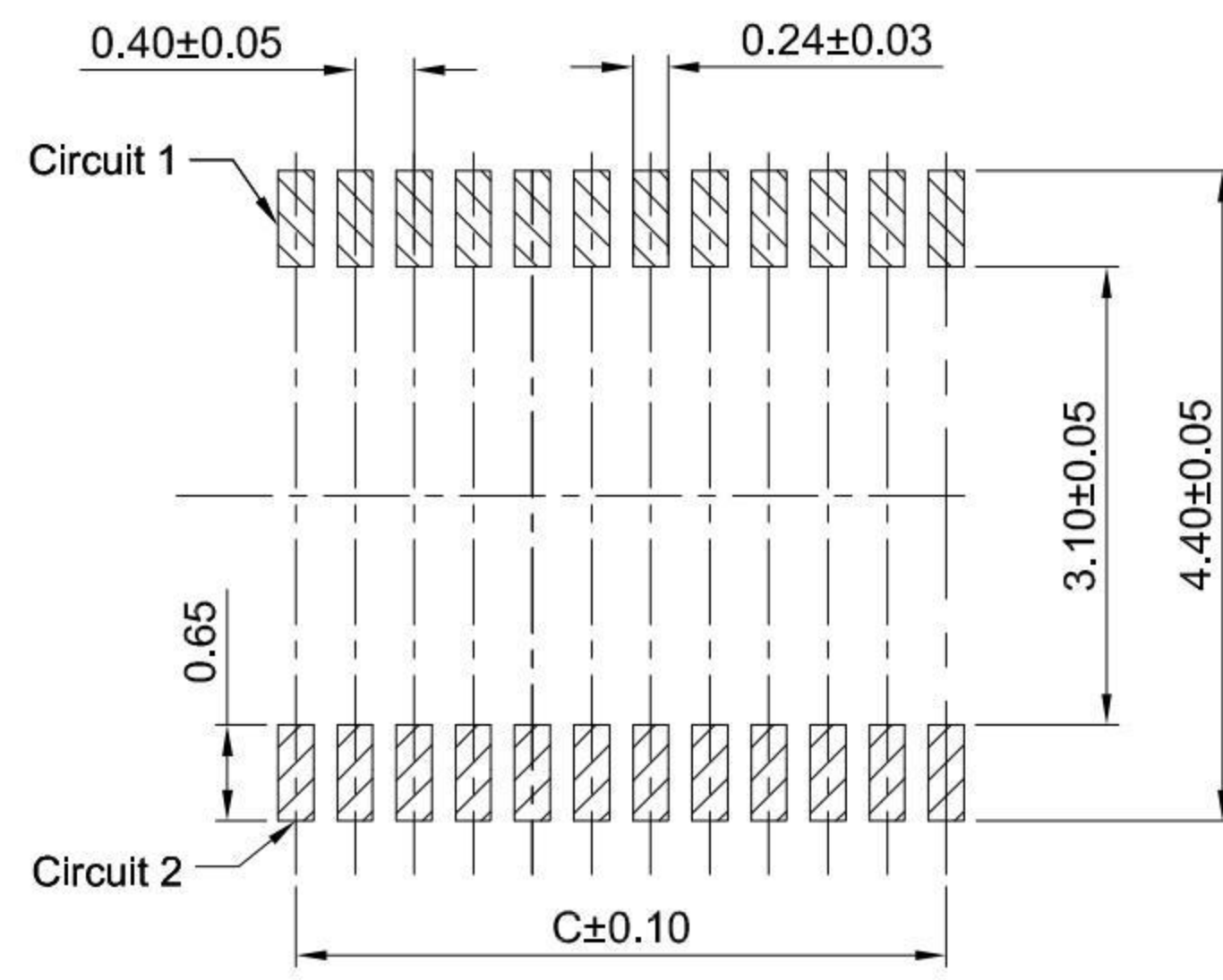
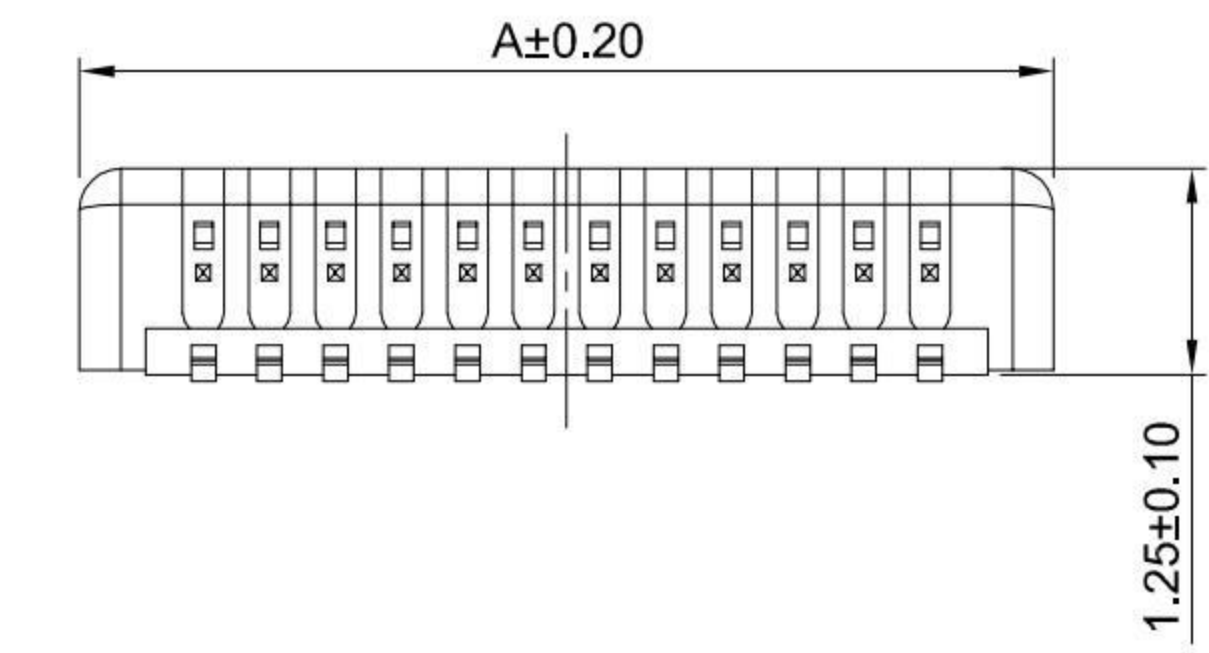

MATING HEIGHT

RECOMMENDED PCB LAYOUT
TOLERANCE:±0.05

Ordering Information:

Circuit	Dimensions(mm)			
	A	B	C	D
20	5.10	4.30	3.60	1.60
24	5.90	5.10	4.40	2.40
30	7.10	6.30	5.60	3.60
34	7.90	7.10	6.40	4.40
40	9.10	8.30	7.60	5.60
50	11.10	10.30	9.60	7.60
60	13.10	12.30	11.60	9.60
70	15.10	14.30	13.60	11.60
80	17.10	16.30	15.60	13.60

NO.	PART NAME	MATERIAL	REMARK
2	CONTACT	PHOSPHOR BRONZE	ALL AU G/F
1	HOUSING	LCP+30%GF,94V-0	BLACK

SCALE: 1:1 UNIT: mm
SIZE: A4

Title: BTB 0.40mm Pitch 180° H1.25mm
Dual Rows SMT Type Mate Connector

Unless otherwise
General Tolerance:
X ±0.40
X.x ±0.30
X.xx ±0.20
X* ±5°
X.x° ±3°

Molde Code: GT-B0405MSV12-XXXXX01

DRAWN	CHECKED	APPROVED	DATE
Hu	Chen	Chen	2022.12.28



REV: A0 SHEET: 1/1

